

7/32" & 5/16" Cased Hole Split Drum

UniTruck



1	TRUCK CHASSIS	International 7500 6x4 Sleeper 14K / 40K Domestic / IHT 570	▼
2	TRUCK WARRANTY	Domestic USA Truck Chassis Cab Warranty	▼
3	TRUCK CAB PAINT	Truck Cab One Color System - ASEP White Or As Supplied	▼
4	TRUCK CAB DECALS	No Truck Cab Decal Applied	▼
5	TRUCK CHASSIS TO BODY INTERFACE	Chassis Components Supplied & Fitted To ASEP Supplied Chassis	▼
6	BODY & WINCH DRUM TO CHASSIS ASSEMBLY	Assembly Of Body & Drum Package To Chassis	▼
7	BODY	UniTruck Body	▼
8	UNDER BODY STORAGE TRAY	Under Body Storage Tray With Air Bags	▼
9	UNDER BODY STORAGE BELLY BOXES	6x4 Chassis Belly Box Set	▼
10	BODY PAINT	UniTruck Body One Color System - ASEP Standard White Color	▼
11	BODY DECALS	No UniTruck Body Decal Applied	▼
12	RIGHT FRONT LOCKER STORAGE LONG HATCH	Right Rear Rack Extends Into Right Front Locker Area	▼
13	RIGHT REAR LOCKER STORAGE LONG HATCH	Tool Storage Rack With Upper & Lower Air Bags	▼
14	LEFT REAR LOCKER STORAGE LONG HATCH	Long Storage Cupboard With Shelves	▼
15	LEFT FRONT LOCKER STORAGE SHORT HATCH	Short Storage Cupboard With Shelves	▼
16	HYDRAULIC OIL RESERVOIR & ELECTRIC GENERATOR MODULE	Hydraulic Oil Reservoir With Intercooler & 30 Kw Generator Module	▼
17	HYDRAULIC OIL RESERVOIR HEATER	No Hydraulic Oil Reservoir Heater Supplied	▼
18	WORKSHOP POWER INPUT CABLE	Power Input Cable 50ft	▼
19	MEASURING HEAD SUPPORT SYSTEM	Single Overhead Support Arm	▼
20	MEASURING HEAD	Client Supplied Measuring Head - Electronic	▼
21	DEPTH / SPEED / TENSION DISPLAY	Client Supplied Depth / Speed / Tension Display - Electronic	▼
22	WINCH CONTROL PANEL	Electric / Hydraulic Winch Control System	▼
23	DOUBLE WINCH BASE	No Winch Drum Base Supplied	▼
24	DOUBLE WINCH BASE UPPER DRUM	No Winch Drum Supplied	▼
25	DOUBLE WINCH BASE UPPER DRUM GEARBOX	No Gearbox Supplied	▼
26	DOUBLE WINCH BASE LOWER DRUM	No Winch Drum Supplied	▼
27	DOUBLE WINCH BASE LOWER DRUM GEARBOX	No Gearbox Supplied	▼
28	SINGLE WINCH BASE	Modular Single Drum Mount	▼
29	SINGLE WINCH BASE GEARBOX	ASEP Single Speed Gearbox 15:1 For Cased Hole	▼
30	SINGLE WINCH BASE WINCH DRUM - FULL WIDTH	No Winch Drum Supplied	▼
31	SINGLE WINCH BASE WINCH DRUM - SPLIT	Winch Drum BC49 Split Magnetic Core	▼
32	SLICKLINE CONFIGURATION 1	No Slickline Configuration Supplied	▼
33	SLICKLINE CONFIGURATION 2	No Slickline Configuration Supplied	▼
34	BRAIDED LINE CONFIGURATION 1	7/32" Braided / Conductor Wire Configuration	▼
35	BRAIDED LINE CONFIGURATION 2	5/16" Braided / Conductor Wire Configuration	▼
36	SLIP RING COLLECTOR 1	8 Ring Slip Ring Collector	▼
37	SLIP RING COLLECTOR 2	No Slip Ring Collector Supplied	▼
38	WIRELINE LUBRICATION SYSTEM	Wireline Lubrication Oil Bar With Reservoir	▼
39	SHEAVE WHEEL STORAGE	Storage Bracket For Four Sheave Wheels	▼

7/32" & 5/16" Cased Hole Split Drum

UniTruck



40	GROUND CABLE & REEL	Ground Cable & Reel	▼
41	SP CABLE & REEL	No SP Cable & Reel Supplied	▼
42	DLL CABLE & REEL	No DLL Cable & Reel Supplied	▼
43	INTERCOM CABLE & REEL	No Intercom Cable & Reel Supplied	▼
44	REMOTE LOAD PIN CABLE & REEL	No Remote Load Pin Cable & Reel Supplied	▼
45	SPARE REEL	No Spare Reel Supplied	▼
46	AIR CONDITIONER	Air Conditioner & Heater For Standard Conditions	▼
47	AUXILIARY HEATER	No Auxiliary Heater Supplied	▼
48	AQUISITION SYSTEM RACK	Client Supplied Short Aquisition System Rack - Right	▼
49	LOW BENCH SEAT	Low Bench Seat	▼
50	HIGH BENCH SEAT	High Bench Seat	▼
51	ENGINEER CHAIR	No Engineer Chair Supplied	▼
52	CD / RADIO	Under Cabinet CD / Radio	▼
53	CABIN COMFORT PACKAGE	No Cabin Comfort Package Supplied	▼
54	CABIN SAFETY PACKAGE	Fire Extinguisher / First Aid Kit / Eye Wash Station	▼
55	INTERCOM	No Intercom Supplied	▼
56	DEHUMIDIFIER	No Dehumidifier Supplied	▼
57	CABIN PRESSURIZATION FAN	No Cabin Pressurization Fan Supplied	▼
58	PORTABLE LIGHT TABLE	No Portable Light Table Supplied	▼
59	GREASE INJECTION SYSTEM	No Grease Injection System Supplied	▼
60	BOP / STUFFING BOX CONTROLS	No BOP / Stuffing Box Controls Supplied	▼
61	BUMPER MOUNTED VICE	4" Work Vice	▼
62	AIR SUPPLY EQUIPMENT	Air Supply Outlet Rear With Air Hose	▼
63	SPARE WHEEL STORAGE RACK	No Spare Wheel Storage Rack Supplied	▼
64	BELLY BOX PULL OUT DRAWER	No Belly Box Pull Out Drawers Supplied	▼
65	BACK UP ELECTRICAL GENERATOR	No Back-Up Diesel Driven Generator Supplied	▼
66	DOT SAFETY PLACARDS	DOT Safety Placards	▼
67	TRUCK SAFETY PACKAGE	No Truck Safety Equipment Supplied	▼
68	WHEEL CHOCKS	No Wheel Chocks Supplied	▼
69	SHEAVE WHEELS & RIG-UP EQUIPMENT	7/32" & 5/16" Cased Hole Rig-Up Package	▼
70	CLIENT SPECIFIED CUSTOM EQUIPMENT 1	No Client Specified Custom Equipment Supplied	▼
71	CLIENT SPECIFIED CUSTOM EQUIPMENT 2	No Client Specified Custom Equipment Supplied	▼
72	CLIENT SPECIFIED CUSTOM EQUIPMENT 3	No Client Specified Custom Equipment Supplied	▼
74	OPERATION & MAINTENANCE MANUAL	CD Format Operation & Maintenance Manual	▼
75	PAYMENT TERMS	30% / 70% Payment Terms	▼
76	DELIVERY	Delivery 24 to 28 Weeks From Receipt of Purchase Order & Deposit	▼
77	TERMS & CONDITIONS & WARRANTY	ASEP Standard Terms & Conditions & Warranties Apply	▼
78	SPECIAL NOTES	No Special Notes	▼

UniTruck



7/32" & 5/16" Cased Hole Split Drum

EQUIPMENT DESCRIPTION

UniTruck Body Basic Equipment

Composite material body equipped with; extruded aluminum floor system, side entrance door with double glazed window, double glazed winch bay window, double glazed right and left side windows, set of standard ribbed aluminium finish internal cupboards, aluminum wall finish package, standard 12V DC electrical and lighting system, 120 V / 60 Hz and 12V DC electrical load centre, fixed winch operator chair, rubber carpet floor set, set of DOT marker lights, rear tool access doors, sliding winch bay door, large side access locker doors, small side access locker door, set of 12V floodlights, set of 12V spotlights, set of 12V winch bay lights, set of 120 V / 60 Hz cabin sockets, set of 120 V / 60 Hz winch bay sockets, set of locks and keys for all doors and hatches.

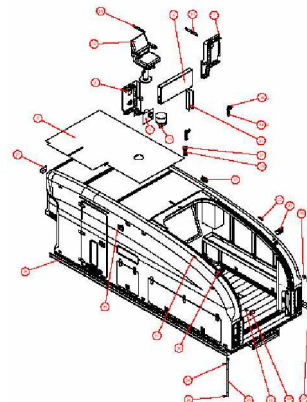

Truck Chassis / Paint / Decals

International 7500 6x4 truck chassis with sleeper cab and chrome package fitted with PTO. International HT 570 330 hp engine with 1150 lb/ft torque, 14,000 lb front axle, 40,000 lb rear axles. Chassis punched to accept chassis components. Chassis purchased and supplied.. Specifications may differ slightly to suit actual requirements. Domestic USA truck chassis warranty.

Truck cab supplied standard white color (Equivalent to RAL 9003) or as colour truck is supplied by client.

No decal applied to truck cab.

Truck & Chassis Interface

Supply and fitting of chassis interface components to include; rear bumper assembly, drum mounts, body mounts, hydraulic lines, pneumatic lines, 12V DC cables and canbus controls to supplied truck chassis.

Upper Body / Belly Boxes / Under Body Storage / Paint / Decals

Refer to UniTruck body basic equipment description above
Under body tool rack assembly for interface between North American truck chassis with mounting points and facility to store maximum 20 ft long x 6" diameter equipment. Two air bag assemblies fitted.

Under body belly box set for 6x4 truck chassis, configured as chassis requires, comprising 24" and 36" long removeable aluminium belly box assemblies attached to extruded aluminum floor of UniTruck body including a set of stowable steps and a set of triangular wheel well fender surrounds.

UniTruck



UniTruck body supplied gel coat finish standard white and lower belly box assemblies and generator module painted standard white color system (RAL 9003).

No decal applied

Upper Storage Behind Body Lockers

Right rear rack extends into right front locker area.

Supplied behind right rear long hatch. 216" long x 12" wide x 48" high aluminum storage rack with four tool storage trays.

Air bags fitted to upper and lower tool storage trays.

Supplied behind left rear long hatch. One 96" long x 12" wide x 48" high aluminum storage cupboard with three shelves rivetted to cupboard carcass.

Supplied behind left front short hatch. One 48" long x 12" wide x 48" high aluminum storage cupboard with three shelves rivetted to cupboard carcass.

Hydraulic & Electrical Power Module

Removeable module fitted on under body storage tray. Located below bench seat area of body and includes hydraulic oil reservoir with hydraulic oil intercooler and hydraulic motor driven 30kW 120V / 60Hz generator.

No hydraulic oil reservoir heater supplied.

Power input cable (50ft) with connector suitable for connection to 120 V / 60 Hz external input connector socket. No connector supplied for external supply connection. Supplied with cable tails only.

Measuring Head & Depth / Speed / Tension Display

Single overhead type measuring head support arm mounted to weatherwall of winch bay area with hydraulic cushioning system including hydraulic accumulator and pressurising hand pump and hydraulic horizontal steering mechanism.

Client supplied measuring head with depth/speed encoder and encoder cable plus tension load pin and tension load pin signal cable. ASEP to fit measuring head to measuring head support arm and route encoder cable and tension load pin cable through weatherwall to cabin. Measuring head to be supplied by client with correct adapter to fit to measuring head support arm.

Client supplied depth/speed/tension display panel. To fit depth/speed/display panel in cabin and connect depth/speed and tension cables routed from weatherwall to cabin. Depth/speed/tension panel dimensions to be supplied by client at time of order.

Winch Controls

Single control lever for electric over hydraulic . Closed Loop Hydraulic System pump and motor controls. All controls for operation of unit integrated into ergonomic and modular control panel module.

UniTruck



Double Drum Waterfall Winch Package

No winch drum base supplied
No winch drum supplied
No gearbox supplied
No winch drum supplied
No gearbox supplied

Single Drum Winch Package

Removeable frame to accept maximum 55" OD / 34" wide drum with single motor / single chain / single air brake.
15:1 ratio (cased hole) single speed planetary gearbox for connection to Closed Loop Hydraulic System.
No full width design winch drum supplied.
49" OD flange / 11" and 18" wide / 20" ID steel core split winch drum

Slickline Wire Configuration

No slickline configuration supplied.
No slickline configuration supplied.

Braided Line / Conductor Line Configuration

Wireline configuration for 7/32" braided or conductor wireline
Wireline configuration for 5/16" braided or conductor wireline

Slip Ring Collectors

Eight ring slip ring collector for mounting to winch drum
No slip ring collector supplied by ASEP.

Wireline Lubrication

Wireline lubrication oil bar fitted to winch drum base with pneumatically pre-charged reservoir.

Sheave Wheel Storage

Storage bracket with retaining chain for four sheave wheel assemblies located in winch bay floor.

Winch Bay Storage Reels

Ground cable and reel fitted.
No spontaneous potential cable and reel supplied
No dual lateral log cable and reel supplied
No intercom cable and reel supplied.
No remote load pin cable and reel supplied
No spare reel supplied.

Heating & Air Conditioning

UniTruck



Air conditioner system 24,000 BTU with integrated 23,000 BTU heater system and remote control panel 120V / 60Hz.
No auxiliary heater supplied .

Data Acquisition

Client supplied short height acquisition system rack fitted to worktop area to right of winch operator chair. Fitting of acquisition system into rack and cabling to be carried out by client.

Personnel Seating

Low bench seat with back rest adjacent to the left of cabin entrance door.
High bench seat with back rest and foot rest fitted to shelf area above generator pod module.
No engineer chair supplied

Cabin Equipment

Under cabinet CD / radio system with integrated speakers.
No cabin comfort package supplied
Fire extinguisher, first aid kit and eye wash station.
No intercom supplied.
No dehumidifier supplied
No cabin pressurization fan supplied
No portable light table supplied

Grease Injection / BOP / Stuffing Box Controls

No grease injection system supplied.
No BOP / stuffing box controls supplied

Body / Chassis Equipment

Work vice for maximum 4" OD workpiece fitting to rear bumper.
Air supply outlet quick connect located at rear of truck with 50ft air supply hose with quick connects.
No spare wheel storage rack supplied
No belly box pull out drawers supplied.
No back-up diesel driven generator supplied
Set of US DoT regulations hazardous materials safety / warning placards fitted to front / right / rear / left of truck.
No truck safety equipment supplied.
No set of wheel chocks with tie back chains supplied.

Sheave Wheels & Rig-Up Equipment

7/32" & 5/16" Cased Hole Split Drum

UniTruck



7/32" & 5/16" cased hole rig-up equipment package. All equipment manufactured by Wireline Technologies Inc. Comprising : (2) 7/32" x 17" diameter composite rigging sheaves with shackle clevis / (2) 5/16" x 17" diameter composite rigging sheaves with shackle clevis / (1) floorstand / (1) handguard assembly / (1) rig-up yoke / (1) sheave hanger T bar / (1) 1/2" x 12ft long chain assembly.

Client Specified Custom Equipment

No client specified custom equipment supplied

No client specified custom equipment supplied

No client specified custom equipment supplied.

Operation & Maintenance Manual

CD format operation & maintenance manual

Delivery

Delivery 24 to 28 weeks from receipt of purchase order & deposit